

Soils Map

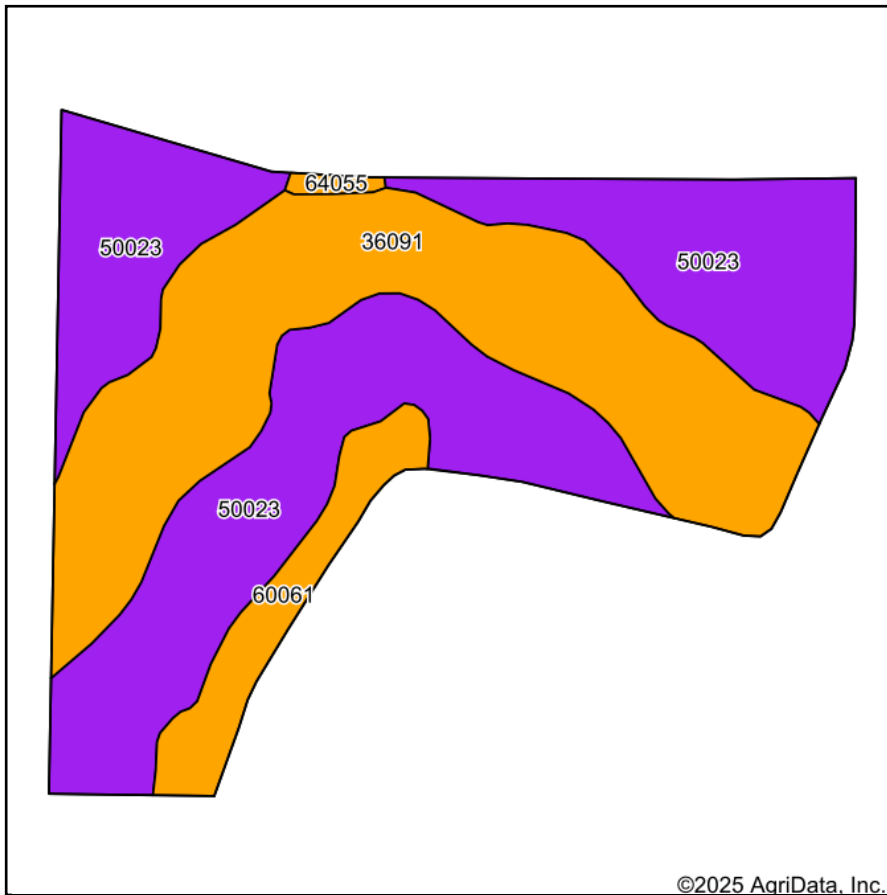

Soils data provided by USDA and NRCS.

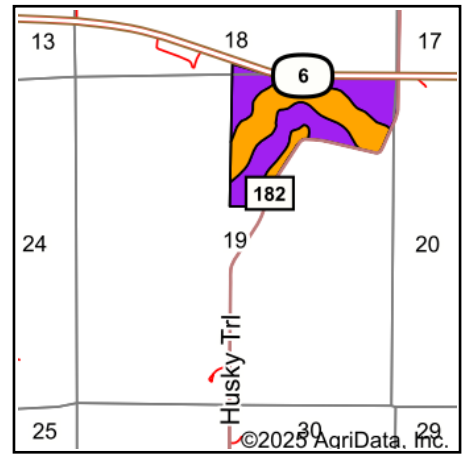

State: **Missouri**
 County: **Adair**
 Location: **19-63N-17W**
 Township: **Morrow**
 Acres: **82**
 Date: **12/11/2025**



Maps Provided By:



© AgriData, Inc. 2025

www.AgriDataInc.com



Area Symbol: MO001, Soil Area Version: 30

Code	Soil Description	Acres	Percent of field	Non-Irr Class Legend	Non-Irr Class *c	Alfalfa hay Tons	Caucasian bluestem Tons	Common bermudagrass Tons	Orchardgrass red clover Tons	Tall fescue Tons	Warm season grasses Tons	*n NCCPI Corn	*n NCCPI Soybeans
50023	Gara fine sandy loam, 14 to 20 percent slopes, eroded	44.50	54.3%		Vle	7	8	7	7	7	8	61	53
36091	Vesser silt loam, 1 to 3 percent slopes, occasionally flooded	31.37	38.3%		Illw			8	7	8	10	78	79
60061	Bevier silty clay loam, 3 to 8 percent slopes	5.69	6.9%		Ille							69	55
64055	Vigar-Zook-Excello complex, 1 to 5 percent slopes	0.44	0.5%		Illw			8	8	8	10	82	67
Weighted Average					4.63	3.8	4.3	6.9	6.5	6.9	8.2	*n 68.2	*n 63.2

*n: The aggregation method is "Weighted Average using all components"

*c: Using Capabilities Class Dominant Condition Aggregation Method

Soils data provided by USDA and NRCS.